

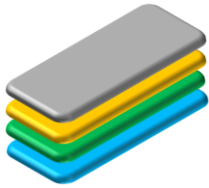

TECHNICAL DATA SHEET

METALLIZED, HEAT SEALABLE CAST POLYPROPYLENE FILM

IMP325



High metal adhesion metallized layer
 Corona treated surface layer
 Transparent CPP core
 High seal strength layer

Metallized, one side heat sealable Cast Polypropylene film suitable for lamination to OPP, Nylon and PET films in dry lamination. IMP325 features good moisture and oxygen barrier, excellent metal adhesion, good optics, superior sealing strength and high lamination bond strength in laminate structures.

PRODUCT FEATURES

- One side corona treated for lamination applications
- High metal adhesion
- Good moisture and oxygen barrier
- Excellent heat seal strength
- Good resistance to fats, oil and grease
- Good UV light barrier

APPLICATIONS

- Laminations requiring a high heat seal strength
- Laminations requiring standard barrier properties
- Products requiring a barrier and heat seal web
- Confectionary and related packages
- General food applications

PROPERTIES	TEST METHOD	UNITS	IMP325	IMP325	IMP325	IMP325	IMP325
GENERAL							
Base Web Thickness	Internal	ga	100	120	140	160	200
	ASTM D1505	lb/ream	14.0	16.8	19.6	22.4	28.0
Yield	Internal	in ² /lb	30900	25700	22100	19300	15500
Treatment Level	Metallized	ASTM D-2578			38		
Metal Adhesion	Internal (EAA)	gf/25mm	>230				
Coefficient of Friction (CoF)	ASTM D-1894	Film - Film	0.50 - 0.80				
MECHANICAL							
Tensile Strength (at break)	MD	ASTM D-882			>5800		
	TD	ASTM D-882	>2900				
Elongation to Break	MD	ASTM D-882	>500				
	TD	ASTM D-882	>500				
THERMAL							
Heat Seal Range		*F	245 - 290				
Heat Seal Strength	265°F/14psi/1sec	g/inch	>650				
Shrinkage (250°F/15 min)	MD	Internal	<1.0				
	TD	Internal	<1.0				
BARRIER							
Water Vapor Transmission Rate	(100°F/90% RH)	ASTM E1249	g/100in ² /24h		0.06		
Oxygen Transmission Rate	(73°F/0% RH)	ASTM D3985	cc/100in ² /24h		7.0		

Guidelines for storage

Temperature should be less than 86°F and humidity 55±5% in storage areas. Material should be consumed within 3 months of receipt. Allow film to reach operating room temperature 24h before use.

Printing & Lamination

Material is suitable for printing and lamination on the metallized side of the material only. In-line corona boost treatment can be used if required. Further information is available from your Impak Films USA LLC representative.

FDA Compliance: For information regarding food contact compliance, please contact your Impak Films representative

Information in this publication refers to average values of reference data and/or laboratory tests on samples from standard production. It is believed to be accurate and is given in good faith, but it is for the customer to determine the suitability of the material for its own particular purpose or application. Accordingly, Impak Films USA LLC gives no warranty as to the fitness of the product for any particular purpose and any implied warranty or condition (statutory or otherwise) is excluded except to the extent that such exclusion is prevented by law. This document is not a product specification. Impak Films reserves the right to amend this product data sheet at any time without prior notification.

IMPAK FILMS AUSTRALIA (www.impakfilms.com.au)
 ABN: 42 586 823 597 Address: Unit 1, 15-21 Butler Way, (P.O. Box 1114), Tullamarine Vic. 3043, Australia Telephone: +61 3 9310 5540 Facsimile: +61 3 9310 5590

IMPAK FILMS USA (www.impakfilms.com)
 Address: 2300 Lake Park Drive, Suite 270, Smyrna, Georgia 30080, USA Telephone: +1 866 606 7896 Facsimile: +1 678 384 5543