

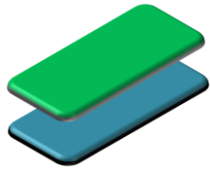

TECHNICAL DATA SHEET

PVOH COATED PET

IMP630



PVOH coated surface

PET Base film

A PVOH coated transparent PET film with high oxygen, aroma and flavor barrier. IMP630 offers good mechanical properties and flex crack resistance. The use of IMP630 in laminate materials can assist in the extension of shelf life in a range of oxygen sensitive food products.

PRODUCT FEATURES

- Excellent oxygen barrier
- Excellent flavor and aroma barrier
- Superior flex crack resistance
- Excellent surface gloss and transparency
- Excellent printability on the PVOH coated side

APPLICATIONS

- Used in laminates to achieve high oxygen barrier properties
- Barrier layer in laminates for cheese, meat, nuts, cereals, flavored, powdered and processed foods
- Suitable for use in a wide range of laminations; product is not heat sealable

PROPERTIES	TEST METHOD		UNITS	IMP630	IMP630
GENERAL					
Base Web Thickness	GB/T6672		ga	43	51
Yield	ASTM D4321		lb/ream	9.2	10.9
			in ² /lb	46900	39600
Treatment Level	PVOH side	GB/T14216	dyne	>44	>44
Haze	Maximum	BG2410	%	2.5	3.0
Coefficient of Friction (CoF)	PVOH-PVOH	GB10006	Kinetic	0.60	0.60
MECHANICAL					
Tensile Strength	MD	ASTM D884	psi	31900	31900
	TD	ASTM D884	psi	31900	31900
Elongation to Break	MD	ASTM D884	%	32	32
	TD	ASTM D884	%	32	32
Shrinkage	MD	Internal	%	1.8	1.8
	TD			0.5	0.5
BARRIER					
Water Vapor Transmission Rate	100°F/90% RH	ISO 15106-3	g/100in ² /24h	1.7	1.6
Oxygen Transmission Rate	73°F/0% RH	ASTM D3985	cc/100in ² /24h	0.05	0.05

Guidelines for storage

Temperature should be less than 86°F and humidity 55±5% in storage areas. Material should be consumed within 6 months of receipt. Allow film to reach operating room temperature 24h before use.

Printing & Lamination

It is recommended to print on the PVOH coated side of the film when used in a laminate structure. Advice should be taken from your ink supplier.

When laminating this material, the use of a lamination film free from migratory additives may give improved results.

FDA Compliance: For information regarding food contact compliance, please contact your Impak Films representative

Information in this publication refers to average values of reference data and/or laboratory tests on samples from standard production. It is believed to be accurate and is given in good faith, but it is for the customer to determine the suitability of the material for its own particular purpose or application. Accordingly, Impak Films USA LLC gives no warranty as to the fitness of the product for any particular purpose and any implied warranty or condition (statutory or otherwise) is excluded except to the extent that such exclusion is prevented by law. This document is not a product specification. Impak Films reserves the right to amend this product data sheet at any time without prior notification.

IMPAK FILMS AUSTRALIA (www.impakfilms.com.au)
ABN: 42 586 823 597 Address: Unit 1, 15-21 Butler Way, (P.O. Box 1114), Tullamarine Vic. 3043, Australia Telephone: +61 3 9310 5540 Facsimile: +61 3 9310 5590

IMPAK FILMS USA (www.impakfilms.com)
Address: 2300 Lake Park Drive, Suite 270, Smyrna, Georgia 30080, USA Telephone: +1 678 384 5520 Facsimile: +1 678 384 5543