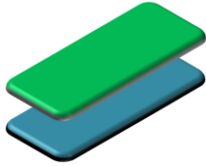

**TECHNICAL DATA SHEET****PVdC COATED PET****IMP626**

PVdC coated surface

PET Base film

A PVdC coated transparent PET film with high oxygen, aroma and flavor barrier. IMP626 offers good mechanical properties and flex crack resistance in laminates. The use of IMP626 in laminate materials can assist in the extension of shelf life in a range of oxygen sensitive food products.

PRODUCT FEATURES

- Excellent oxygen, carbon dioxide and nitrogen gas barrier
- Excellent flavor and aroma barrier
- Superior flex crack resistance
- Excellent surface gloss and transparency
- Excellent printability on the PVdC coated side

APPLICATIONS

- Used in laminates to achieve high gas barrier properties
- Barrier layer in laminates for cheese, meat, nuts, cereals, flavored, powdered and processed foods
- Barrier layer for overwrap applications such as cosmetics and personal care products

PROPERTIES	TEST METHOD	UNITS	IMP626	IMP626	IMP626
GENERAL					
Base Web Thickness	GB/T6672	ga	47	55	60
Yield	ASTM D4321	lb/ream	10.6	12.4	13.2
		in ² /lb	40650	35000	32700
Treatment Level	PVdC side	GB/T14216	dyne	>50	>50
Haze	Maximum	ASTM D1003	%	3.5	3.5
Coefficient of Friction (CoF)	PET - PET	ASTM D1894	Kinetic	0.40 - 0.50	0.40 - 0.50
MECHANICAL					
Tensile Strength	MD	ASTM D884	psi	28100	28100
	TD	ASTM D884	psi	26700	26700
Elongation to Break	MD	ASTM D884	%	105	105
	TD	ASTM D884	%	105	105
BARRIER					
Water Vapor Transmission Rate	100°F/90% RH	ISO 15106-3	g/100in ² /24h	0.52	0.52
Oxygen Transmission Rate	73°F/0% RH	ASTM D3985	cc/100in ² /24h	0.45	0.45

Guidelines for storage

Temperature should be less than 86°F and humidity 55±5% in storage areas. Material should be consumed within 6 months of receipt. Allow film to reach operating room temperature 24h before use.

Printing & Lamination

It is recommended to print on the PVdC coated side of the film when used in a laminate structure. Advice should be taken from your ink supplier.

When laminating this material, the use of a lamination film free from migratory additives may give improved results.

FDA Compliance: For information regarding food contact compliance, please contact your Impak Films representative

Information in this publication refers to average values of reference data and/or laboratory tests on samples from standard production. It is believed to be accurate and is given in good faith, but it is for the customer to determine the suitability of the material for its own particular purpose or application. Accordingly, Impak Films USA LLC gives no warranty as to the fitness of the product for any particular purpose and any implied warranty or condition (statutory or otherwise) is excluded except to the extent that such exclusion is prevented by law. This document is not a product specification. Impak Films reserves the right to amend this product data sheet at any time without prior notification.

IMPAK FILMS AUSTRALIA (www.impakfilms.com.au)

ABN: 42 586 823 597 Address: Unit 1, 15-21 Butler Way, (P.O. Box 1114), Tullamarine Vic. 3043, Australia Telephone: +61 3 9310 5540 Facsimile: +61 3 9310 5590

IMPAK FILMS USA (www.impakfilms.com)

Address: 2300 Lake Park Drive, Suite 270, Smyrna, Georgia 30080, USA Telephone: +1 678 384 5520 Facsimile: +1 678 384 5543