

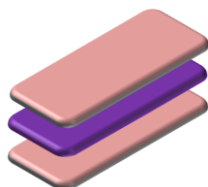

TECHNICAL DATA SHEET

TWO SIDE ACRYLIC COATED BOPP

IMP605



Acrylic coated surface
BOPP Base film
Acrylic coated surface

A two side acrylic coated transparent BOPP, one side is suitable for printing, the other side for heat sealing. IMP605 is specifically designed to give outstanding machine performance characteristics in HFFS applications.

PRODUCT FEATURES

- Superior printability on the acrylic coated print surface, the material can be printed on both sides if required
- Broad seal range on the acrylic coated seal side
- Outstanding optical properties
- High seal strength
- Good aroma barrier

APPLICATIONS

- Designed for high speed, high performance HFFS applications
- Best machine results are obtained when IMP605 is used in a lamination

PROPERTIES	TEST METHOD	UNITS	IMP605	IMP605	IMP605	IMP605	
GENERAL							
Base Web Thickness	GB/T6672	ga	82	100	120	160	
Yield	Q/SN2	lb/ream	12.1	14.3	17.1	22.7	
		in ² /lb	35600	30100	25200	19000	
Treatment Level	Print side	GB/T14216	dyne	42	42	42	42
Haze	Maximum	GB2410	%	1.5	2.0	2.5	2.5
Gloss	45°	GB/T8807	%	90.0	90.0	90.0	90.0
Coefficient of Friction (CoF)	Both sides	GB10006	Kinetic	0.25	0.25	0.25	0.25
MECHANICAL							
Tensile Strength	MD	GB/T13022	psi	18900	18900	18900	18900
	TD	GB/T13022	psi	36300	36300	36300	36300
Elongation to Break	MD	GB/T13022	%	180	180	180	180
	TD	GB/T13022	%	65	65	65	65
Shrinkage (250°F / 30min)	MD	Q/SN2	%	2.0	2.0	2.0	2.0
	TD	Q/SN2	%	1.0	1.0	1.0	1.0
Seal Strength (260°F/0.75sec/20psi)	Acrylic/Acrylic	Q/SN2	g/in	380	380	380	380
Seal Strength 200g/inch @	Acrylic/Acrylic	Q/SN2	*F	180	180	180	180
BARRIER							
Water Vapor Transmission Rate	100°F/90% RH	ISO 15106-3	g/100in ² /24h	0.43	0.39	0.33	0.28
Oxygen Transmission Rate	73°F/0% RH	ASTM D3985	cc/100in ² /24h	64.5	55.5	49.7	41.9

Guidelines for storage

Temperature should be less than 86°F and humidity 55±5% in storage areas. Material should be consumed within 6 months of receipt. Allow film to reach operating room temperature 24h before use.

Printing & Lamination

It is recommended to print on the indicated Acrylic coated side of the film as both sides are specially formulated for their indicated purpose (print or seal). Advice should be taken from your ink supplier.

Ideal processing temperature range is 50 - 85°F

FDA Compliance: For information regarding food contact compliance, please contact your Impak Films representative

Information in this publication refers to average values of reference data and/or laboratory tests on samples from standard production. It is believed to be accurate and is given in good faith, but it is for the customer to determine the suitability of the material for its own particular purpose or application. Accordingly, Impak Films USA LLC gives no warranty as to the fitness of the product for any particular purpose and any implied warranty or condition (statutory or otherwise) is excluded except to the extent that such exclusion is prevented by law. This document is not a product specification. Impak Films reserves the right to amend this product data sheet at any time without prior notification.