

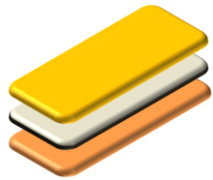

TECHNICAL DATA SHEET

HEAT SEALABLE, WHITE OPAQUE CPP FILM

IMP310



Corona treated surface layer
White opaque CPP core
Heat sealable layer

One side treated, one side heat sealable white opaque cast polypropylene suitable for lamination to OPP, Nylon and PET films in dry and extrusion lamination processes. IMP310 has a high level of whiteness and opacity and imparts superior sealing strength, good moisture barrier and high lamination bond strength to laminate structures. IMP310 can be used in single web applications and in direct food contact.

PRODUCT FEATURES

- One side corona treated for print and lamination uses
- Good moisture barrier
- High whiteness and opacity
- Excellent heat seal strength
- Excellent lamination bond strength

APPLICATIONS

- Laminations requiring a high heat seal strength
- Suitable for chilled and frozen applications
- Products requiring excellent opacity in packaging design
- General food applications

PROPERTIES	TEST METHOD	UNITS	IMP310	IMP310	IMP310
GENERAL					
Base Web Thickness	Internal	ga	100	120	160
Yield	ASTM D1505	lb/ream	14.0	16.8	22.4
Treatment Level	Corona	ASTM D-2578	38	38	38
Coefficient of Friction (CoF)	ASTM D-1894	Film - Film	<0.40	< 0.40	< 0.40
MECHANICAL					
Tensile Strength (at break)	MD	ASTM D-882	psi	>5800	>5800
	TD	ASTM D-882	psi	>2900	>2900
Elongation to Break	MD	ASTM D-882	%	>500	>500
	TD	ASTM D-882	%	>500	>500
THERMAL					
Heat Seal Range			*F	245 - 290	245 - 290
Heat Seal Strength	265°F/14psi/1sec		g/inch	>650	>650
Shrinkage (250°F/15 min)	MD	Internal	%	<1.0	<1.0
	TD	Internal	%	<1.0	<1.0
BARRIER					
Water Vapor Transmission Rate	(100°F/90% RH)	ASTM E1249	g/100in ² /24h	0.88	0.78
Oxygen Transmission Rate	(73°F/0% RH)	ASTM D3985	cc/100in ² /24h	270	235

Guidelines for storage

Temperature should be less than 86°F and humidity 55±5% in storage areas. Material should be consumed within 3 months of receipt. Allow film to reach operating room temperature 24h before use.

Printing & Lamination

Material is suitable for printing and lamination on the corona treated side of the material only. In-line corona boost treatment can be used if required. Further information is available from your Impak Films USA LLC representative.

FDA Compliance: For information regarding food contact compliance, please contact your Impak Films representative

Information in this publication refers to average values of reference data and/or laboratory tests on samples from standard production. It is believed to be accurate and is given in good faith, but it is for the customer to determine the suitability of the material for its own particular purpose or application. Accordingly, Impak Films USA LLC gives no warranty as to the fitness of the product for any particular purpose and any implied warranty or condition (statutory or otherwise) is excluded except to the extent that such exclusion is prevented by law. This document is not a product specification. Impak Films reserves the right to amend this product data sheet at any time without prior notification.