

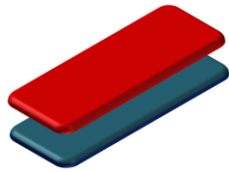

TECHNICAL DATA SHEET

ONE SIDE CHEMICAL TREATED PET FILM FOR PE ADHESION

IMP208



Chemical treated Polyester layer

Transparent polyester core

Transparent biaxially oriented polyester film, one side chemically treated, suitable for printing and high bond strength adhesion to polyethylene.

PRODUCT FEATURES

- Suitable for printing on the chemically treated side
- Designed to give high bond strength to polyethylene without primer in extrusion lamination applications.
- Suitable for dry laminations to polyethylene and other flexible materials

APPLICATIONS

- Printed extrusion laminated rewinds, pouches, sachets and bags of IMP208 to Polyethylene
- Fresh and dried foods
- Snack foods and other high barrier flexible laminates

PROPERTIES	TEST METHOD		UNITS	IMP208	IMP208	IMP208	IMP208	IMP208
GENERAL								
Thickness*		Internal	ga	48	60	92	144	200
Density		Internal	g/cm ³			1.40		
Yield		Internal	lb/ream	10.3	12.9	19.8	31.0	43.0
		Internal	in ² /lb	41850	33500	21800	14000	10100
OPTICAL								
Haze	max	ASTM D-1003	%	3.5	3.5	4.0	4.5	5.0
MECHANICAL								
Tensile Strength	MD	ASTM D-882	psi	28800	28800	29800	28400	27000
	TD	ASTM D-882	psi	31300	31300	31300	29800	28400
Elongation to Break	MD	ASTM D-882	%			120		
	TD	ASTM D-882	%			110		
Shrinkage 300°F / 30 min	MD	ASTM D-1204	%	2.0	2.0	2.0	1.8	1.6
	TD	ASTM D1204	%	0.4	0.4	0.4	0.4	0.4
Film Melting Point		DSC	°F			490		
Coefficient of Friction	Static	ASTM D-1894				0.45		
	Dynamic	ASTM D-1894				0.40		
BARRIER								
Water Vapor Transmission Rate	(100°F/90% RH)	ASTM E96	g/100in ² /24h	2.60	2.60	1.40	1.00	0.60
Oxygen Transmission Rate	(73°F/0% RH)	ASTM D3985	cc/100in ² /24h	6.50	6.50	4.50	3.20	2.60

* Thicker materials may be available on request

Guidelines for storage

IMP208 should be stored at below 105°F in its original wrapping and away from sources of direct sunlight.

Printing & Lamination

Consult with your ink and adhesive suppliers for appropriate materials for use with this product.

FDA Compliance: For information regarding food contact compliance, please contact your Impak Films representative

Information in this publication refers to average values of laboratory tests on samples from standard production. It is believed to be accurate and is given in good faith, but it is for the customer to satisfy the suitability for its own particular purpose. Accordingly, Impak Films gives no warranty as to the fitness of the product for any particular purpose and any implied warranty or condition (statutory or otherwise) is excluded except to the extent that such exclusion is prevented by law. This document is not a product specification. Impak Films reserves the right to change the data sheet at any time without prior notification.

IMPAK FILMS AUSTRALIA (www.impakfilms.com.au)

ABN: 42 586 823 597 Address: Unit 1, 15-21 Butler Way, (P.O. Box 1114), Tullamarine Vic. 3043, Australia Telephone: +61 3 9310 5540 Facsimile: +61 3 9310 5590

IMPAK FILMS USA (www.impakfilms.com)

Address: 2727 Paces Ferry Road, Suite 1650 Building One, Atlanta, Georgia 30339, USA Telephone: +1 678 384 5520 Facsimile: +1 678 384 5543